

User Manual

Slide Kamera HG-2 head is dedicated for camera cranes, HKR-2 camera crane in particular and Slide Kamera devices. It allows to mount various accessories in a variety of combinations, what provides great configuration possibilities and universality of our products.



Slide Kamera HG-2 Head



Pdf version of the manual available for download: www.slidekamera.eu



Before you start your work with Slide Kamera HG-2 we strongly recommend to read the manual carefully. Please note that using the device in a manner inconsistent with the instructions, unauthorized repair attempts or any kind of modification can cause a damage the manufacturer is not responsible for.

- In case of damage during transport you are required to submit:
- ☒ proof of purchase
 - ☒ protective styrofoam inserts/ fillers included in the set in case of new product delivery

If you fail to comply with the abovementioned conditions, the manufacturer reserves the right to refuse the complaint.

Photos of the products may slightly differ from the actual product due to constant modifications and improvements introduced by the manufacturer.

Table of contents

1.Elements and construction of Slide Kamera HG-2 head.....2

2.Description and operation.....3

3.Mounting devices on Slide kamera HG-2 head.....3

3.1.Mounting Slide Kamera HKR-2 camera crane on HG-2 head with the use of AKC-3 adapter.....3

3.2.Mounting Slide Kamera HKR-2 camera crane directly on HG-2 head.....5

3.3.Mounting Slide Kamera HGO-2 rotational head on HG-2 head.....6

3.4.Mounting Slide Kamera device on HG-2 head with the use of AKC-3 adapter.....7

4. Maintenance and operation.....8

5.Transport.....8

6.Terms of warranty.....9

Slide Kamera ®

High Engineering Technology CNC s.c.
Sebastian Pawelec Karol Mikulski
Glińa 45
82-522 Sadlinki
Vat Identification Number: 581-188-33-32

Slide Kamera Office

80-175 Gdańsk (Poland)
Ul. Kartuska 386

tel./fax (+48) 58 710 41 04
e-mail: biuro@slidekamera.pl / office@slidekamera.eu
www.slidekamera.pl / www.slidekamera.eu

1. Elements and construction of Slide Kamera HG-2 head

Once you receive shipment please make sure that all the elements of Slide Kamera HG-2 head are inside.

Included in the set:

- | | |
|---|--|
| <input checked="" type="checkbox"/> User Manual | <input checked="" type="checkbox"/> AF-11 LG reduction 1/4"-3/8" mandrel |
| <input checked="" type="checkbox"/> Slide Kamera HG-2 head | <input checked="" type="checkbox"/> Four M4x12 screws |
| <input checked="" type="checkbox"/> Head handle | <input checked="" type="checkbox"/> Four M4x20 screws |
| <input checked="" type="checkbox"/> AF-12 LG reduction 3/8" mandrel | <input checked="" type="checkbox"/> Two 3/8" counternuts |

Slide Kamera HG-2 head construction:

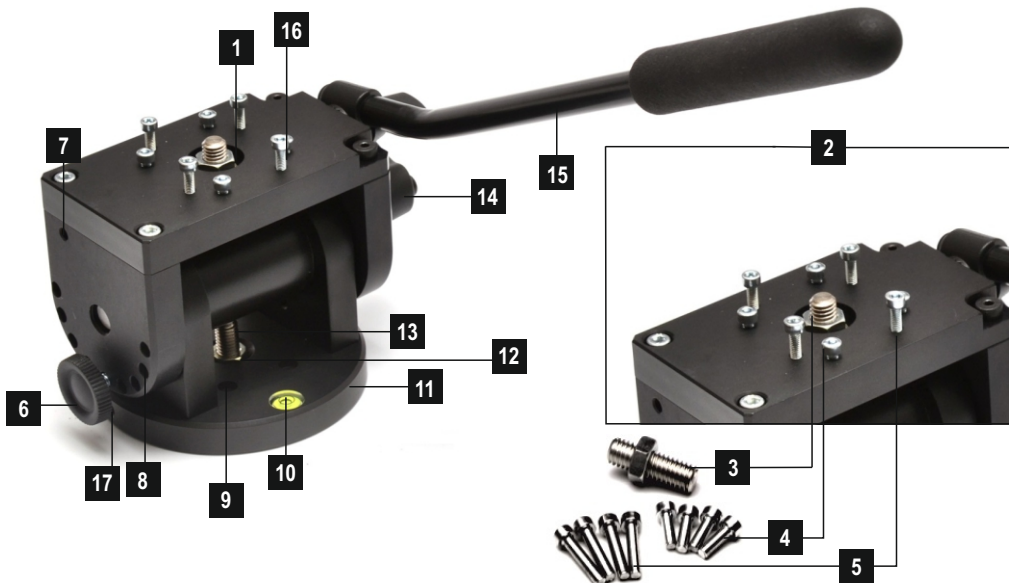

Upper threaded hole with 3/8" hardened insert [1]

Mounting plate [2]

AF-11 LG reduction 1/4"-3/8" mandrel with a counternut [3]

Four M4x12 screws [4]

Four M4x20 screws [5]

Locking knob with M6 thread [6]

M6 hole into which you can screw the locking knob (when using clamping lever only) [7]

M6 holes for locking the head in a specified angular position (when using locking knob) [8] (hole spacing 180°)

Four M4 holes [9] (lower M4 holes)

Bubble level [10]

Head base plate [11]

Lower threaded hole with 3/8" hardened insert [12]

AF-12 LG reduction 3/8" mandrel with counternut [13]

Clamping lever [14]

Head handle [15]

Eight M4 holes [16] (upper M4 holes)

Two 1/4" holes placed on base plate sides [17] (holes located on the opposite sides)

2. Description and operation

Slide Kamera HG-2 head is dedicated for camera cranes, HKR-2 camera crane in particular and Slide Kamera devices. It allows to mount various accessories in a variety of combinations, what provides great configuration possibilities and universality of our products.

PLEASE NOTE:

Slide Kamera HG-2 head is not a VIDEO head and it is not suitable for working with your camera or photo camera.
Slide Kamera HG-2 head is not a fluid head.

Slide Kamera HG-2 head construction is made of aluminum.

Range of head tilt :180°.

Maximum permissible load: 40kg.

HG-2 head is equipped with two 1/4 " holes [17] placed on both sides of the base plate [11]. The holes allow to attach accessories to the head, for example, on-camera field monitor. It is also equipped with clamping lever [14] used to lock the head in a desired position. When blocking the position of HG-2 head with locking knob we achieve high stability and rigidity of the device, what is extremely important when working with heavy loads. If you use only the clamping lever, screw the locking knob into M6 hole [7].

There are M4 holes on both mounting and base plate: sequentially eight upper holes [16] and four lower holes [9]. The holes allow to mount accessories, such as : AKC-3 adapter plate or HGO-2 rotational head. Holes spacing allows to mount Manfrotto adapter.

3. Mounting other devices on Slide Kamera HG-2 head

Slide Kamera HG-2 head is equipped with a number of holes that allow to mount various accessories in a variety of combinations, thus providing great configuration possibilities and universality of our product.

Table showing configuration possibilities of Slide Kamera HG-2 head

HG-2 HEAD MOUNTING PLATE	Mounting hole	Dedicated device	Screws
	Four M4 holes (Manfrotto spacing)	Slide Kamera AKC-3 adapter Manfrotto adapter	4 M4x12 screws
	Four M4 holes	Slide Kamera HKR-2 camera crane	4 M4x20 screws
HG-2 HEAD BASE PLATE	Four M4 holes	Slide Kamera HGO-2 rotational head	4 M4x20 screws

3.1. Mounting Slide Kamera HKR-2 camera crane on HG-2 head with the use of AKC-3 adapter.

Unscrew AF-11 LG reduction 1/4"-3/8" mandrel with a counternut and all the screws from the HG-2 head mounting plate.

Threaded hole with 3/8" hardened insert [1]



AF-11 LG reduction 1/4"-3/8" mandrel with a counternut [2]
M4x12 screws [3]
M4x20 screws [4]

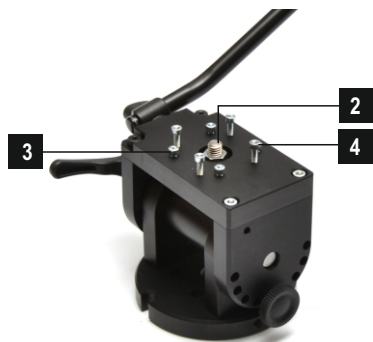

Remove the 3/8" and 1/4" screws from the mounting plate of the crane (screws attach the equipment to the mounting plate of the crane).

Mounting plate of the crane [1]
3/8" photographic screw [2]
1/4" photographic screw [3]

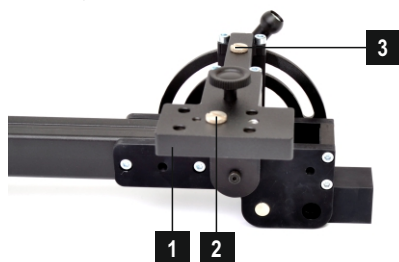

Eject Slide Kamera AK-101 sliding plate from Slide Kamera AKC-3 adapter, remove all screws (use Allen wrench 2.5 mm and 3 mm).



Screw the AK-101 sliding plate [2] to the crane mounting plate [1] using 4 M4 screws (screws added to AKC-3 adapter) by inserting them into the holes in the crane mounting plate.

Crane mounting plate [1]
AK-101 sliding plate [2]

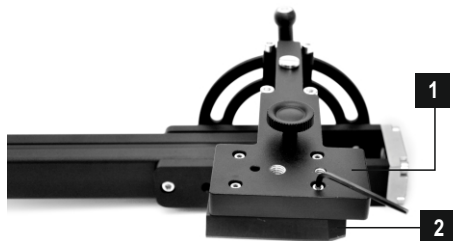

Screw AKC-3 adapter base to the mounting plate of HG-2 head using four M4x12 screws (added to HG-2 head).

Two clamping knobs that lock Slide Kamera AKC-3 adapter [1]
M4x12 screws [2]
Slide Kamera AKC-3 adapter base [3]
Slide Kamera HG-2 head [4]
Slide Kamera HG-2 head handle [5]

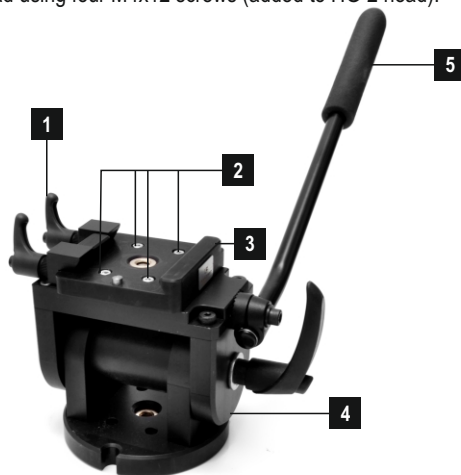

Slide AK-101 sliding plate into AKC-3 adapter base mounted on the head and lock the clamps [3]. You can remove the head handle for a more convenient assembly. Before you insert crane mounting plate into the adapter base it is crucial that the adjustment knob [1] is maximally unscrewed. Use the adjustment knob to level the arm of the crane.

Level adjustment knob [1]
Crane mounting plate with
Slide Kamera AK-101 sliding plate attached [2]
AKC-3 adapter locking clamps [3]



Alternatively, you can replace the AKC-3 Slide Kamera adapter with Manfrotto MN577 Adapter equipped with the Manfrotto 501PL sliding plate.

3.2 Mounting Slide Kamera HKR-2 crane directly on HG-2 head

Unscrew AF-11 LG reduction 1/4"-3/8" mandrel with a counternut [2] and all the screws from the HG-2 head mounting plate. To make the mounting easier, remove the head handle [5] and clamping lever [6]

Threaded hole with 3/8" hardened insert [1]
AF-11 LG reduction 1/4"-3/8" mandrel with a counternut [2]
M4x12 screws [3]
M4x20 screws [4]
Head handle [5]
Clamping lever [6]

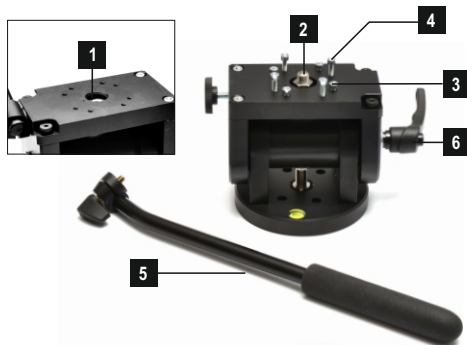

With the use of four M4x20 screws [3] assemble the crane mounting plate to the HG-2 Slide Kamera head. **It is crucial so that HG-2 head clamping lever [5] is on the opposite side in relation to the arm of the camera crane.** Use to adjustment knob [2] to level the arm of the crane.

- Arm tilt clamping knob [1]
- Crane level adjustment knob [2]
- M4x20 screws [3]
- Slide Kamera HG-2 head [4]
- Slide Kamera HG-2 clamping lever [5]



3.3. Mounting Slide kamera HGO-2 rotational head on HG-2 head

Remove four M4x12 [1] screws and AF-12LG reduction 3/8" thread with a counternut [2] screwed into the rotational head plate.



Place Slide Kamera HG-2 head [1] on Slide Kamera HGO-2 rotational head [2] in a way so that M4 holes overlap. Unscrew four M4x20 screws [3] from HG-2 mounting plate and screw them into lower M4 holes [4] of the HG-2 head. This allows to obtain HG-2/HGO-2 heads set.

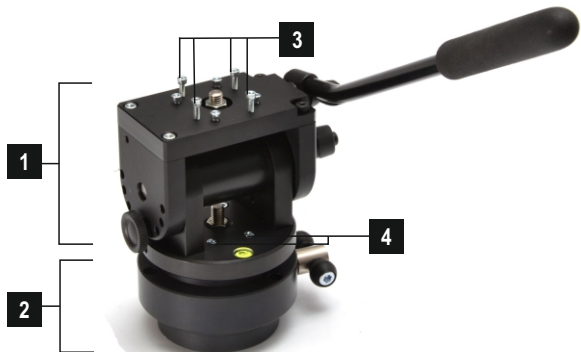

- Slide Kamera HG-2 head [1]
- Slide Kamera HGO-2 rotational head [2]
- Four M4x20 screws [3]
- Four lower M4 holes [4]

3.4. Mounting Slide Kamera device on HG-2 head with the use of AKC-3 adapter.

Mounting AKC-3 Slide Kamera adapter to the AF-8 lower port (added to every Slide Kamera device) allows to quickly dismount the device from the accessory such as tripod, rotational head or any other.

Slide the AK-101 sliding plate from AKC-3 adapter base and remove all screws except for 3/8" [3] and 1/4" [2] photographic screws and the grub screw [4] that locks them.



Mount Slide Kamera AK-101 sliding plate to AF-8 lower port using 1/4" and 3/8" photographic screws



Screw AKC-3 adapter base to the HG-2 mounting plate using four M4x12 screws (added to HG-2 head).

Two clamping knobs that lock Slide Kamera AKC-3 adapter [1]

M4x12 screws [2]

Slide Kamera AKC-3 adapter base [3]

Slide Kamera HG-2 head [4]

Slide Kamera HG-2 head handle [5]



Unlock AKC-3 adapter clamping knobs [1], slide AK-101 sliding plate [2] mounted to the AF-8 lower port [3] of the Slide Kamera device [4]. Lock the clamping knobs.

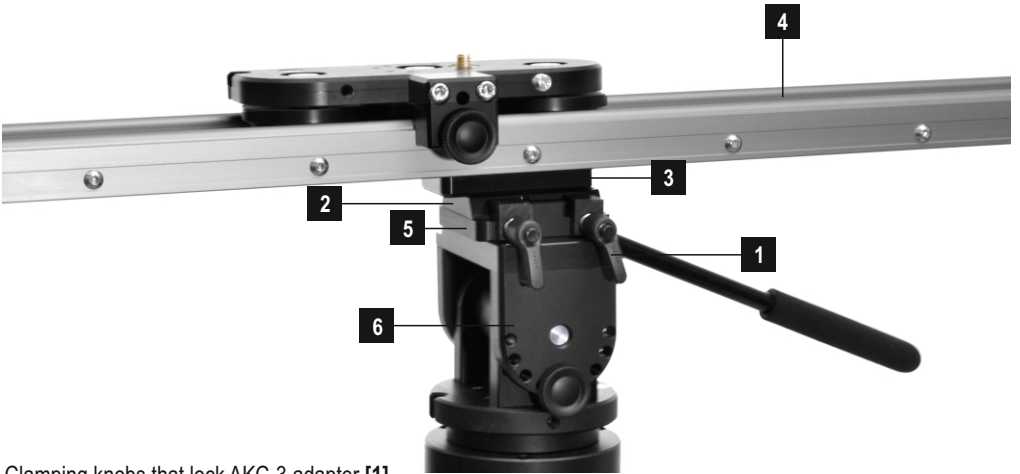

- Clamping knobs that lock AKC-3 adapter [1]
- AK-101 sliding plate [2]
- AF-8 lower port [3]
- Slide Kamera device [4] (in the picture: Slide Kamera HSK-5)
- AKC-3 adapter base [5]
- Slide Kamera HG-2 head [6]

4. Maintenance and operation

Slide Kamera HG-2 head does not require any additional service or lubrication of the components. Maintenance procedures are reduced to keeping the equipment clean.

Any changes in the design and repairs are made only and exclusively by the manufacturer.
Failure to comply with the recommended guidelines outlined in this manual will result in loss of warranty.

5. Transport

During transport Slide Kamera HG-2 head handle is unscrewed and properly protected. Locking knob and clamping lever are locked.

6. Terms of warranty

All Slide Kamera products are covered manufacturer's warranty for a period of 12 months from the date of sale. Warranty covers any faults of the design or of the material of the product which resulted in the product malfunctioning. The warranty covers the repair, or, if the repair proves impossible, replacement of the product with a new one. However, the cost of repairing the product cannot overrun the catalogue value of the product. The warranty does not cover damage and / or product defects resulting from the improper usage, as well as not following product maintenance specifications.

The warranty excludes:

- ☒ unauthorized attempts to repair or modify
- ☒ mechanical damage caused during transport and operation of such features, scratches, dents, pits, dirt, etc...
- ☒ flooding, moisture

To obtain warranty service the purchaser should deliver the damaged product together with a proof of purchase and proof of payment (invoice, cash register receipt). The product will be accepted for warranty service on condition that it will be delivered with correctly filled in complaint form and properly protected during transport.

After the warranty period is exceeded any spare parts can be purchased directly from the manufacturer or in any selected points of sale: **www.slidekamera.pl / www.slidekamera.eu.**

The manufacturer runs also a post warranty service: HET-CNC s.c., 80-175 Gdańsk (Poland), Ul. Kartuska 386

PLEASE NOTE: Any package shipped on HET-CNC s.c., 80-175 Gdańsk, Ul. Kartuska 386 cost will not be received.

